

Installation Instructions: LED Emergency Non Maintained Downlight, DALI Addressable (09155)

Date	Revision
10.1.25	1

Read these instructions before installation and retain for future reference.
This equipment should be installed by a competent electrician



Important Information

We recommend that luminaires are installed by a qualified electrician ensuring the installation complies with current IEE wiring regulations BS7671:2018 & local building control.

- BELL will not accept responsibility for any claims arising from a poor installation.
- The light source of this luminaire is not replaceable: when the light source reaches end of life, the whole luminaire must be replaced.
- Always switch off mains supply before installing.
- All tests should be carried out in accordance to EN 50172:2004
- Do not cover with any insulation

This product may contain substances that can be hazardous to the environment if not disposed of properly. Electrical and electronic equipment should never be disposed of with general household waste but must be separated for its correct treatment and recovery. Where possible recycle your packaging.



- Supply Voltage: 220-240VAC 50/60Hz
- Insulation Class: II
- Ingress Protection: IP20
- Battery Recharge Time: 24h(EU)
- Max Battery Temperature: 60°C
- Ambient Temperature: 0-35°C
- Charge indicator: Green LED
- Deep Discharge Protection DDP
- Assembly indoors to flat surface
- Non-maintained Operation

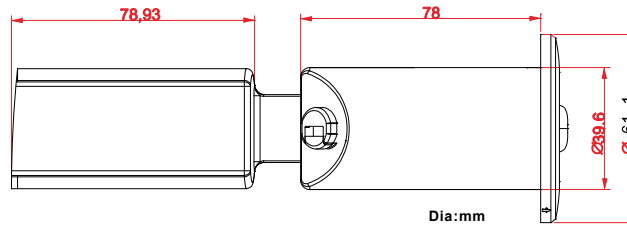

Connections

Line 1:
L: BROWN
N: BLUE
Line 2:
DL: RED
DL: BLACK

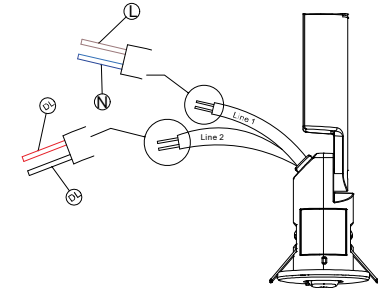

Mounting Options

Battery replacement steps Step 1: Plug the battery into the product

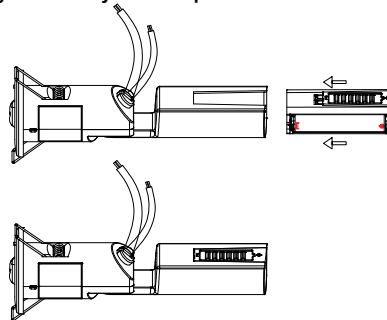

Replacement battery: Push the battery out with a screwdriver

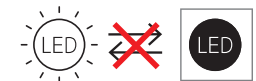
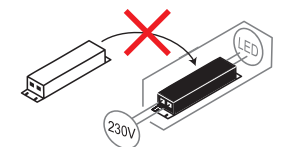
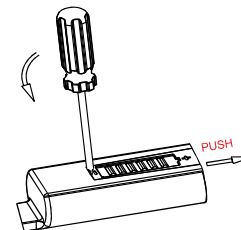

Read these instructions before installation and retain for future reference.
This equipment should be installed by a competent electrician



Step 2: wiring

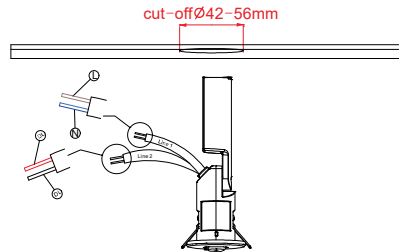

Step 3: Install the product on the ceiling. First, press the spring up and push the product into the hole.

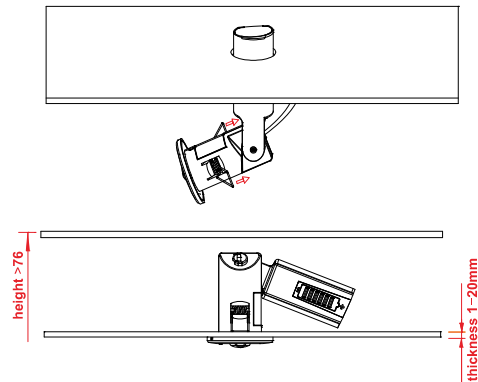

Attention: replace the lens

Step 1: Use a screwdriver to pry open the cover

Step 2: Remove the cover and change the lens.

Step 3: Put back the cover

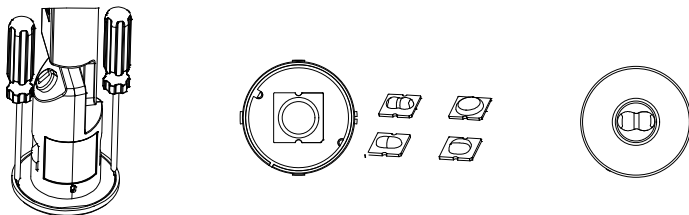

DALI Control:

A DALI command from a suitable control unit can be used to initiate function and duration tests at individually selected times. Status flags are set for report back and data logging of results. When a DALI bus has not been connected or when a DALI bus is connected but the DALI default DELAY and INTERVAL times have not been re-set by sending appropriate DALI commands, then the PIL will conduct self-tests in accordance with the default times set within the EEPROM. These default times are factory pre-set, in accordance with the DALI standard EN 62386-202, to conduct an automatic function test every 7 days and a duration test every 52 weeks. Since the DELAY time is factory pre-set to Zero, all units are tested at the same time. Test times can be changed with a command over the DALI bus. The DELAY and INTERVAL time values must be re-set when the emergency system test times are to be scheduled by a DALI control and monitoring system. Note that once the default values have been set to Zero, tests will only be conducted following a command from the control system. If the DALI bus is disconnected the PIL does not revert to self-testing mode.

Addressing:

For single handed addressing using this method it is necessary to send a broadcast identify command every 3 to 9 seconds. During this command the LEDs will be switched off and the indication LED of green will flash for about 10 seconds.

Rest Mode / Inhibit Mode

Emergency operation is automatically started when the mains supply is switched off.

If the Rest Mode is activated, the discharging of the battery will be minimized by switching off the LED output.

If the Inhibit Mode has been activated before the mains supply is switched off, Rest Mode will be automatically switched on if the mains supply is switched off within 15 minutes. REST Mode and Inhibit Mode can be initiated by the DALI controller. The REST command has to be sent after the mains supply has been disconnected and while the PIL is in emergency operation. The inhibit command has to be sent while the PIL is supplied by mains.

After a mains reset the PIL exits the Rest Mode. Rest Mode and Inhibit Mode can both be disabled by sending the RE-LIGHT/RESET INHIBIT command.

Indicator LED System status is locally by a bi-color indicator LED.

LED Indication	Status	Description
Permanent Green	Standby, System OK	Mains Operation, battery is charged
Fast flashing Green (0.25s on 0.25s off)	Function test underway	Function test underway
Slow flashing Green (1s on 1s off)	Duration test underway	Duration test underway
Permanent Red	Lamp failure	Open Circuit or Short circuit or LED failure
Fast flashing Red	low battery voltage	low battery voltage during charging
Slow flashing Red (1s on 1s off)	Battery fault	Incorrect battery voltage or Short circuit or Open Circuit
Green and Red off	Battery Operation	Emergency mode: Mains disconnected or Mains failure

NOTICE

Fault status:
If an error is detected, the indicator LED switches to RED. If the error has been corrected please re-connecting the battery after the mains power off, the indicator LED immediately switches back to GREEN when mains power on.
If a battery capacity failure occurs, the status of "duration test failed" at DALI interface will be "Yes"